



We're going on a field trip to



# Tubbs' Berry Farm!

We will be going on a hayride, picking a pumpkin, and playing in the straw mazes!

There are also straw slides, a petting zoo, and a farm playground with lots of fun activities. We will also learn a little about honeybees and how plants grow! We will be outside on the farm so please make sure I am wearing clothes that can get dirty and will let me run and play! Fall can get cold so watch the weather and make sure I have a coat, gloves and a hat if I might need them!

When:

What to bring:

Directions: Tubbs Berry Farm is located in Twin Falls on 3800 N between 2700 E and 2800 E (Grandview Drive S). To get there from Addison Ave W (Hwy 30) turn South on Grandview Drive South. Go 1 mile to 3800 N. Turn right (W), farm entrance is 1/2 mile on the right (North) side. (We are about a mile south and a mile west of the old hospital.)

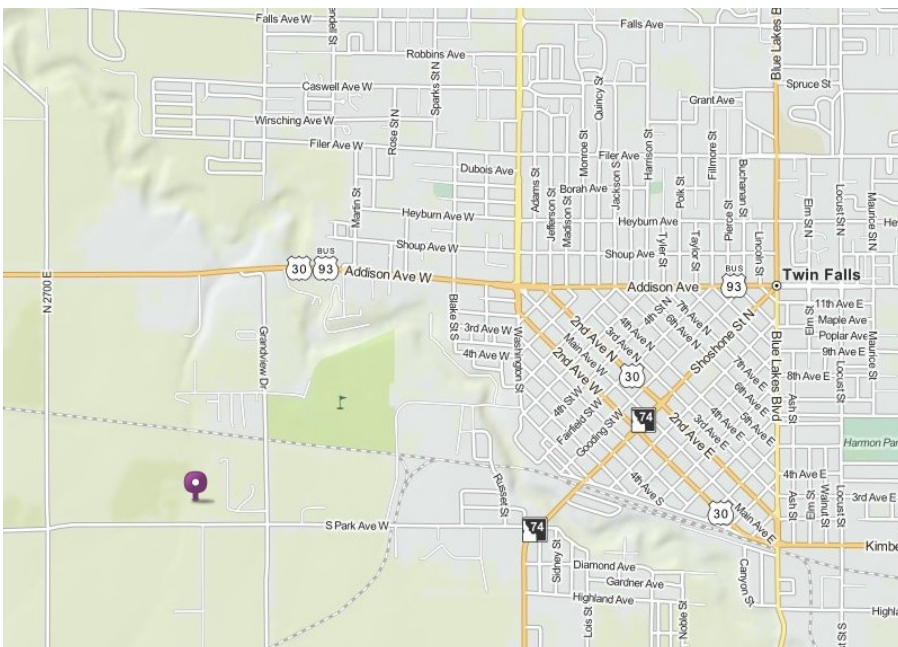

Tubbs Berry Farm  
1150 S Park Ave W  
Twin Falls, Idaho

[www.TubbsBerryFarm.com](http://www.TubbsBerryFarm.com)

208-961-0969